

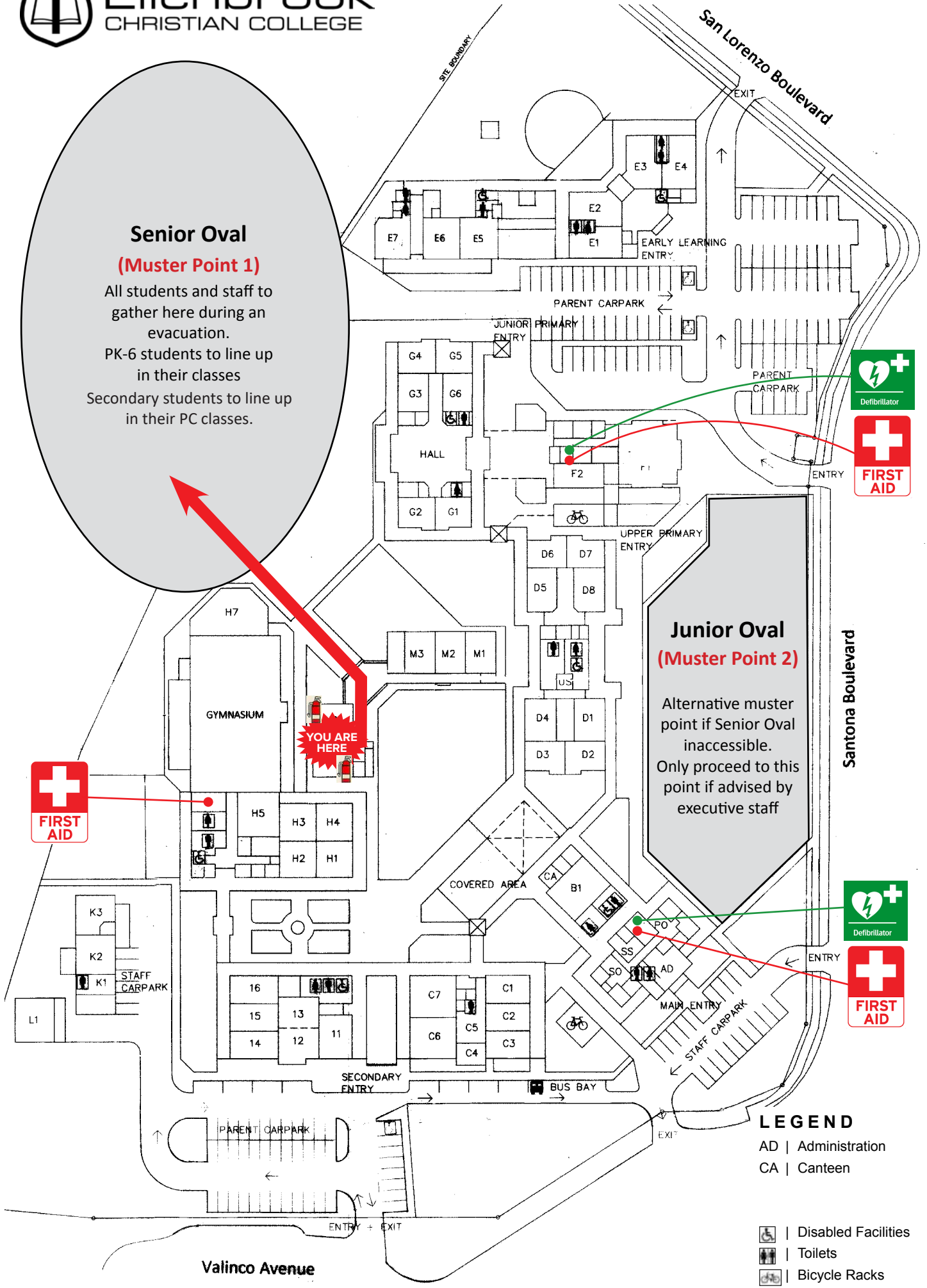

**Senior Oval**  
**(Muster Point 1)**  
All students and staff to gather here during an evacuation.  
PK-6 students to line up in their classes  
Secondary students to line up in their PC classes.

**Junior Oval**  
**(Muster Point 2)**  
Alternative muster point if Senior Oval inaccessible.  
Only proceed to this point if advised by executive staff

**YOU ARE HERE**



**LEGEND**

- AD | Administration
- CA | Canteen

- Disabled Facilities
- Toilets
- Bicycle Racks